

**KILLARNEY COMMUNITY CENTRE ARENA**  
**6260 Killarney St. Vancouver**

**Health Check**

VMHA members must **complete the TeamSnap Health Check PRIOR to arrival at the arena**. Health Check can be found in Event Details and is available 8 hours before the event.

A designated team official will check participants in and confirm the Health Check has been completed. Individuals will not be permitted to enter the building if the Health Check is incomplete/failed.

**Entrance/Timing**

**Please arrive no more than 20 minutes prior to your ice time.** Players and designated team officials will be allowed into the building 10 minutes before ice time. **No spectators are permitted.**

**Masks are required.** Players may remove their masks prior to stepping on the ice (helmets on). Off-ice, participants must wear masks at all times while in the building.

**Arena entrance is at the west end of the arena (south of the main community centre entrance)** and will be marked with a VMHA logo. Please wait in this area (mask on, 2m from others) until the Rink Attendant opens the door for your group.

**Practices**

**Please come to the rink mostly dressed.** There will be marked areas for players to put on their skates, helmets & gloves.

Dressing areas are limited to 19 participants each. Participants are to remain in the dressing area until a Rink Attendant lets them on to the ice. All personal belongings will remain in the dressing area until the players leave the arena.

**Water stations are NOT available.** Please fill your bottles before leaving for the rink.

No off-ice activities (dry-land/warm-up/stretching) are permitted inside the building.

At the end of the session, **participants will have FIVE (5) MINUTES to** remove the minimum equipment required to **exit the arena** (skates, helmets & gloves).

## Games

**Dressing areas are not used. Water stations are NOT available.**

No off-ice activities (dry-land/warm-up/stretching) are permitted inside the building.

**Players\* on BOTH teams arrive COMPLETELY dressed** (with skate guards, helmets AND masks) and **proceed to their respective benches immediately upon entering the facility.** It is recommended that players bring a small bag to hold their water bottle, skate guards, masks, etc. **Hockey bags are not permitted.**

\*Goaltenders from both teams may arrive partially dressed and use a designated dressing area to put on their skates and pads. Coaches and officials (referees/linesmen) are also permitted to use this area.

**At the end of the game, players will return to the bench, put on their masks and skate guards, and exit the facility immediately.**

## Additional Information

City of Vancouver arena capacity (games) is 45 participants; players, team officials, referees/linesmen, score & time-keepers only. NO SPECTATORS.

Arena map attached.

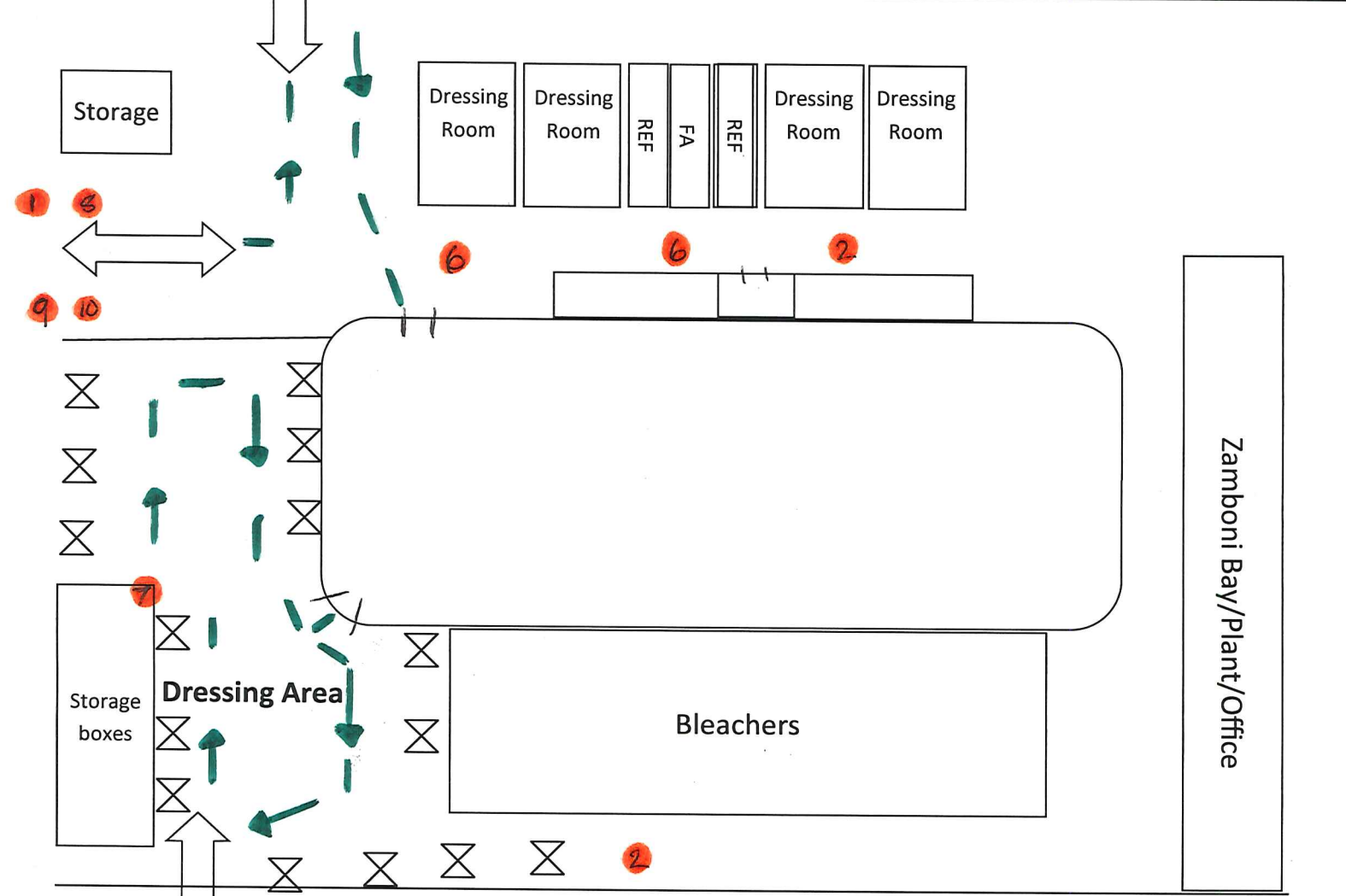
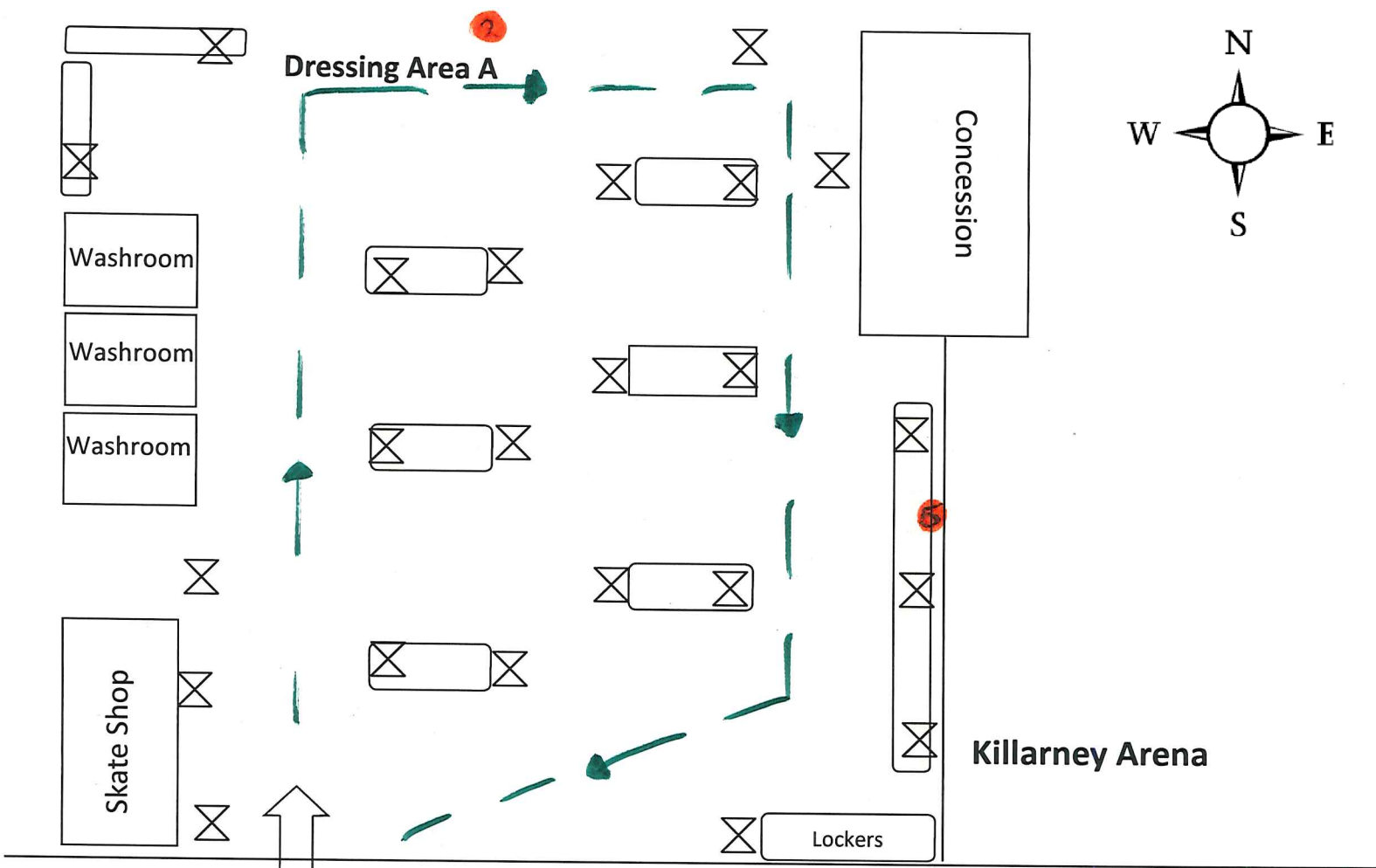

Signage:

- |                      |                       |
|----------------------|-----------------------|
| ○ 1. Rink Entrance A | ○ 2. Do not Enter     |
| ○ 3. Rink Entrance B | ○ 4. Do not endter    |
| ○ 5. Dressing Area A | ○ 6. Yeild            |
| ○ 7. Dressing Area B | ○ 8. 2m distance      |
| ○ 9. Exit A          | ○ 10. prevention tips |
| ○ 11. Exit B         | ○ 12.                 |